

# **2021 SMG – UNIV OF SEOUL Master of Urban Administration and Planning**

Seoul, Korea



Seoul Metropolitan Government (SMG)



International School of Urban Sciences (ISUS)  
University of Seoul (UOS)



# CONTENTS

<b>Part I</b>	<b>WELCOME MESSAGE</b>	2
<b>Part II</b>	<b>PROGRAM OVERVIEW</b>	5
<b>Part III</b>	<b>PROGRAM CONTENTS</b>	6
1.	ACADEMIC SCHEDULE	6
2.	CURRICULUM	7
3.	EXTRACURRICULAR ACTIVITIES	9
4.	SMG-UOS SCHOLARSHIP PROGRAM REGULATIONS	10
<b>Part IV</b>	<b>TRAINING INSTITUTE</b>	11
1.	GENERAL OVERVIEW OF UNIVERSITY OF SEOUL (UOS)	11
2.	INTERNATIONAL SCHOOL OF URBAN SCIENCES (ISUS)	12
3.	ACCOMMODATION	13
4.	OTHER INFORMATION	17
5.	HEALTH CARE	24
<b>Part V</b>	<b>SUPPORT SERVICE</b>	25
1.	TRAVEL TO KOREA	25
2.	EXPENSES FOR STUDY AND LIVING	25
3.	INSURANCE	26
4.	SAFETY MANAGEMENT	29
<b>Part VI</b>	<b>REGULATIONS</b>	30
1.	PARTICIPANT'S RESPONSIBILITIES	30
2.	WITHDRAWALS	31
3.	TEMPORARY LEAVE	31
4.	ACCOMPANYING OR INVITING FAMILY	32
5.	OTHERS	32
<b>Part VII</b>	<b>CONTACTS</b>	33

## Part I WELCOME MESSAGE



### The Leading Education & Research Institution in Urban Sciences in Korea

서순탁

**Suh, Soon Tak**  
President, University of Seoul

The history of the University of Seoul is the history of Korea in view of social development. Since its establishment in 1918, the University of Seoul has changed its specialized area from agriculture, to industry in the 1970's, and again to urban studies in the 1980's. The university of Seoul has become more prestigious in recent years as it develops strategically Urban Studies. As the only university sponsored by the Seoul Metropolitan Government, the University of Seoul is leading the education and research in Urban Studies in Korea.

Urbanization becomes a crucial phenomenon now, and the developing world is where this drastic urbanization is occurring. For the first time, more than half of world population live in cities. Over 90 percent of urban growth is taking place in the developing world. Urbanization in the developing world was once considered unmanageable and hence restricted. However, the question is not how to constrain urbanization, but how to prepare for it, maximizing the benefits of urbanization while minimizing the negative externalities of congestion, crime, and slums. Urban planners and administrators need to understand city and urbanization for better quality of life and socioeconomic prosperity.

Seoul Metropolitan Government and University of Seoul (SMG-UOS) jointly offer a master degree program of urban planning and administration, especially designed for public officers of cities from developing countries. It aims to enable public officers to enhance their ability to improve quality of their citizens' lives by providing world-class theoretical knowledge and Seoul's practical development experiences.

The University of Seoul warmly welcomes to all the SMG-UOS Master of Urban Administration and Planning participants and encourages all of you to keep your passion.

Thank you.



## Hub of 'International Networking' for Global Experts

**Park, Hyeon**  
Dean of ISUS, University of Seoul

In the midst of rapid urbanization during the process of compressed economic growth our country has accumulated unique experiences and know-hows in urban development and administration field. Such urban growth of the Republic of Korea has helped gain the attention of many countries abroad hoping for an opportunity of sharing the experience. Meanwhile, although our construction companies have won high reputation in infrastructure development such as road, harbor and plant construction, the turning point for a qualitative take off has become necessary as the competition with other development-pursuing countries intensified.

Like so, having the domestic and foreign demand in consideration, providing a comprehensive solution relative to the urban development and management with our experience and know-hows and opening the way to the comprehensive package of urban development towards the whole world have become a national agenda that we must pursue. During the process, we anticipate further overseas expansion of the Korean construction companies by the development of new modules.

University of Seoul, which pioneered through the research and education of urban related fields, has met such demands of the current era by establishing the International School of Urban Sciences with the goal of fostering global city professionals in 2012. On one hand, we educate domestic city professionals so that they will be able to advance towards overseas urban development and management fields, and on the other hand, we provide foreign public officials the opportunity to learn the experience of Korea first-handedly by managing the International Urban Development Program (IUDP). In addition, our graduate school will be the platform on which domestic professionals and foreign public officials cultivate global perspectives and insights by interacting with each other and create an international network.

The ISUS is committed to establishing itself as the center of research and international cooperation in the area of urban sciences.

We expect your continued interest and support. Thank you.

## University of Seoul, The Birthplace of Korea's Urban Study

The University of Seoul was founded in 1918 and has provided higher education opportunities for the intelligent, motivated, and creative scholars. As a public institution, the University of Seoul is committed to addressing the social, regional, technological, and creative issues of the urbanized world. It has thus dedicated itself to cultivating leaders who will shape the urban future of Korea and the world. Its faculty, students, and administrative body are also distinguished by a commitment to civic values and a dynamic urban civilization.

The University of Seoul insists on quality and breadth. It is committed to both theory and practice, and endorses openness towards students and Korea's noticeable institutions. With more than 10,000 students enrolled, the University of Seoul consists of seven undergraduate colleges and almost 90 fields of study in the Graduate School. With diverse and specific programs that integrate research and policy, practice and education, the University of Seoul seeks a balance between academic and professional concerns, between visionary goals and practical research. Along with basic research, the University of Seoul functions as a think-tank in formulating and supporting the major policy goals of the Seoul Metropolitan Government.

In this sense, the International School of Urban Sciences has maintained a dominant position in a field of urban sciences. These range from environmental and civic engineering, architecture, urban planning and landscape design to public law and administration, taxation science, economics, urban sociology and management. With Korea's largest and finest group of human and informational resources focused on the future of the world's city, it boasts a unique array of research institutions working on the solutions to its problems and creative visions for its future.



<b>Part II</b>	<b>PROGRAM OVERVIEW</b>
----------------	-------------------------

■ **Program Title:** Master of Urban Administration & Planning (MUAP)

■ **Duration:**

- August 2021 ~ August 2023 (25 months)
  - ON-campus Education: Students will take courses for 13 months (Aug. 2021 ~ Aug. 2022) in the International School of Urban Sciences, University of Seoul
  - Off-campus Education: Students will prepare a thesis for 9 months (Sep. 2022 ~ May. 2023) in his/her home country and submit a completed thesis by June 2023
- Master's Degree (Master of Urban Administration & Planning) will be granted in August 2023

■ **Objectives:**

- To train mid-career public officials who specialize in city planning and urban administration by learning Seoul's successful development cases and experiences.
- To give opportunities to experience Korean culture and to learn language that can increase students' understanding of Korea
- To develop a basis for collaborative relations between Seoul and its sister cities

■ **Hosting Institution:** International Urban Development Program (IUDP),  
International School of Urban Sciences, University of Seoul

■ **Language:** English

■ **Qualification**

- Applicant Qualification
  - Foreign nationals whose parents are both foreign nationals
  - Applicants who have excellent command of both spoken & written English
  - Applicants who are in good health (Pregnancy is regarded as a disqualifying condition)
- Career Qualification
  - Governmental officials who experienced more than 3 years and under 40-year-age
  - College graduates or those with equivalent degrees

■ **Financial Support:** The Following expenses will be covered by SMG & UOS

- Tuition & Dormitory fees
- Economy class, round-trip airfare between Seoul and the Participant's home country
- Monthly living allowance based on SMG regulations
- Others : A medical checkup after arrival / Official field trip expenses

**Part III****CONTENTS****1. ACADEMIC SCHEDULE**

Date	Contents
August, 2021	Preliminary Session (including Arrival, Medical Checkup, Orientation)
September ~ December, 2021	Fall Semester (1 <sup>st</sup> semester)
November ~ December, 2021	Application for Thesis Advisor (1 <sup>st</sup> semester)
December, 2021 ~ February, 2022	Winter Session (Internship)
March ~ June, 2022	Spring Semester (2 <sup>nd</sup> semester)
June, 2022 ~ August, 2022	Summer Session (Thesis Presentation Session)
August, 2022	Departure
August, 2022 ~ February 2023	Thesis Writing
March 2023	Interim Thesis Examination
June 2023	Final Thesis Examination
August 2023	Graduation

\* The schedule above is subject to change.

**a. Preliminary Session (4 Weeks)**

Students are required to take a preliminary session before the first academic semester begins. The preliminary session is designed to help students adjust successfully to the program. Non-credit courses including Korean language & culture, academic writing will be offered during the session. Issuing foreign registration card, medical checkup, and Korean cultural experiences, etc. will be done aside from the coursework.

*\*Some programs may be online or canceled due to COVID-19.*

**b. Regular Coursework Semesters (Fall and Spring Semesters)**

Students are required to complete 45 credit hour coursework during two regular academic semesters. During the Winter Session between the two semesters, an internship or job shadow opportunity may be offered to enhance the students' practical understanding of urban and regional development. After completing the course work, students are required to pass a thesis submission qualification exam.

**c. Thesis Presentation Session (Summer Session)**

After completing the required coursework, students will be required to write a Master thesis under the guidance of his/her advisor. Interim thesis draft will be tested on two thesis presentation sessions, where participants will present his/her thesis draft to be evaluated by thesis committee members.



## 2. CURRICULUM

### a. Curriculum

Students are required to take at least 51 credits for graduation.

Course Category		Course Title	Credit
Common	Core	Global Project Development I	3
		Global Project Development II	3
Major	Core	Thesis Seminar	3
		Research Methodology and Quantitative Analysis	3
Major	Electives (Select 6)	Urban Planning and Development	3
		Urban Design and Historic Preservation	3
		Seminar on Public Investment Management	3
		Geographic Information Systems	3
		Urban Growth and Employment	3
		Environment and Climate Change	3
		E-Government	3
		Housing and Land Policy	3
		Seminar on the Korean Territorial Development Strategies and Cases	3
		Urban Administration and Finance	3
		Development of Smart city	3
		Urban Transportation Planning	3
		Transportation and Infrastructure	3
		Transport and Sustainable Urban Development	3
Language		Basic Korean 1,2 / Academic Writing 1,2	8
Internship		Internship	1
Thesis		Thesis Writing	6
Total		-	51

\* The courses are subject to change.

**b. Required Grade Point Average (GPA)**

- Students with a GPA below 3.0 for two consecutive semesters will be automatically expelled from the program.
- Minimum cumulative GPA for graduation within the 16 months of resident is B0 (3.0/4.5). Students with a GPA below 3.0 will be disqualified from acquiring a diploma or a graduation certificate.

**c. Thesis Writing**

- Each participant should decide his/her thesis adviser during 1<sup>st</sup> semester and submit his/her thesis proposal (or research plan) on thesis qualification examination during 2<sup>nd</sup> semester.
- Interim thesis draft will be tested on two Thesis Research Seminars during Summer Session, where participants will present his/her thesis draft to be evaluated by thesis committee members.
- After going back to his/her own countries, participants are supposed to proceed their thesis study with an adviser by e-mail and so on.
- In the 4<sup>th</sup> semester, two thesis examination will be held officially, and those who passed 1st thesis examination along are eligible for final thesis examination.

### 3. EXTRACURRICULAR ACTIVITIES

#### a. Field Studies

##### 1) Site Visits

- The program will arrange four half-day site visits which can help students gain more practical knowledge of urban and regional development.
- The site visits will also include cultural activities which can help students better understand Korean culture and society.

##### 2) Field trips

- The program will offer two field trips which can provide students opportunities to learn exemplary development projects in different parts of Korea – southeastern and southwestern parts of Korean peninsula.

#### b. Internship/Job Shadow Opportunities

The program will provide internship opportunities for the students to gain more practical knowledge of urban and regional development in Korea at sponsoring or cooperating agencies. The students will be able to do an internship/job shadow during the winter break session or thesis writing session. Students will take the advantage of the opportunity to gain advices, and collect data for thesis writing from institutions where they will do an internship.

#### c. Events

- Welcoming Ceremony and Orientation
- Home Visiting
- Sports Day
- Cultural Events
- Seminars, Forums, and Conferences

※ It is subject to change due to COVID19 situation.

## **4. SMG-UOS SCHOLARSHIP PROGRAM REGULATIONS**

- General Regulations:

All students are required:

- To abide by the rules of the training institution.
  - To maintain a grade at the level required by UOS for the scholarship recipients.
  - To return to his/her home country upon completion of their training program.
  - To participate in every type of curricular and extracurricular events designated by UOS
  - Not to engage in activities or any form of employment for profit or gain.
  - Not to extend the length of his/her training program for personal convenience.
  - Not to bring any family members (dependents) to Korea (except purpose of short tour in Korea)
  - To accept that SMG and UOS are not liable for any damage or loss to his/her personal property.
  - To accept that SMG and UOS will not assume any responsibility for illness, injury, or death caused by extracurricular activities, willful misconduct, or undisclosed pre-existing medical conditions.
  - To carry out such instructions and abide by such conditions as may be stipulated by both SMG and UOS with respect to the training program.
- If the participants fail to meet the above conditions, the home institutions of the program participants can be deprived of further opportunities to make recommendation for future programs.
  - UOS may cancel the admission if a medical check-up shows that the participant has any infectious disease, or diseases which he/she suffers to interrupt your study.
  - Temporary withdrawal is not allowed in principle.
  - If the participant is found to be in violation of any of the above regulations during his/her stay in Korea, his/her status as a MUAP Program participant can be suspended or terminated.

## Part IV TRAINING INSTITUTE

### 1. GENERAL OVERVIEW OF UNIVERSITY OF SEOUL (UOS)



University of Seoul is a public university funded and supported by the Seoul Metropolitan Government. Seoul is the economic, political, and cultural center of Korea. It is also the 600-year capital of Korea, a historical city with social, cultural, and physical layers spread out along a vast and complex landscape. The character of the university, academic programs, and research institutions is shaped by Seoul's metropolitan dynamic. Its faculty, students, and administrative body are distinguished by a commitment to civic values and a dynamic urban civilization. Along with basic research, it functions as a think-tank in formulating and supporting the major policy goals of the Seoul Metropolitan Government. With diverse and specific programs that integrate research and policy, practice and education, the University of Seoul seeks a balance between academic and professional concerns, between visionary goals and practical research.

University of Seoul has set a clear goal of becoming an international center for the urban sciences. These range from environmental and civic engineering, architecture, urban planning and landscape design to public law and administration, taxation science, economics, urban sociology and management. More recently, the university has diversified this base to include the arts and humanities. In the area of science and engineering, the university has concentrated on the development of information and media technology. With Korea's largest and finest group of human and informational resources focused on the future of the world's city, it boasts a unique array of research institutions working on the solutions to its problems and creative visions for its future.

For more information, please visit <http://www.uos.ac.kr/en/>

## **2. INTERNATIONAL SCHOOL OF URBAN SCIENCES (ISUS)**



The International School of Urban Sciences (ISUS) of University of Seoul (UOS) was launched in Spring 2013 in an effort to contribute to the development of sustainable urban communities in the world through an interdisciplinary program of teaching, research, and outreach. ISUS offers two graduate programs in global construction management and sustainable urban & regional development. The two-year graduate degree programs seek to provide an

interdisciplinary, engaged learning environment in which students from various fields acquire the knowledge and professional skills necessary for becoming leading practitioners in the field of environment policy and sustainable development.

In addition to the regular graduate programs, ISUS created the International Urban Development Program (IUDP) in cooperation with partner agencies and institutions in order to share Korea's achievement in urban and regional development with scholars and practitioners from the world. Currently, IUDP offers the Seoul Case Study Program in partnership with several world-renowned public administration and public policy schools in the U.S., and the U.K. The one-week field study program provides graduate students from partner universities with a unique opportunity to learn the best practices of Seoul in various urban administration and development areas. Each year, IUDP also invites about 20 government officials from Seoul's global partner cities for a master's degree program, Master of Urban Administration and Planning (MUAP). The MUAP program, sponsored by Seoul Metropolitan Government is designed for municipal government officials from Seoul's global partner cities to acquire academic and professional knowledge and skills that can help them work for the special challenges their home communities have been facing with. Since 2015, ISUS has developed Master's program for Future Global Leaders in Environmental Policy (MGLEP), sponsored graduate degree program, in partnership with the Ministry of Environment of Korea (KME) for government officials from KME's partner countries. ISUS recently launched another sponsored graduate degree program in global infrastructure development, Master of Infrastructure Planning & Development (MIPD) in partnership with Ministry of Land, Infrastructure and Transport (MOLIT) for government officials from partner countries. These sponsored graduate programs are expected to contribute to the sustainable urban development in developing countries by providing the academic and professional skills necessary for their home countries.

### 3. ACCOMMODATION



Students will reside in a single room either at International House or Guest House on campus. The university's on-campus housing facilities, the Dormitory and International House has 190 rooms for male and 103 rooms for female students. Living on campus allows students to meet new friends and experience all that UOS campus offers through various living, dining, and campus life options.

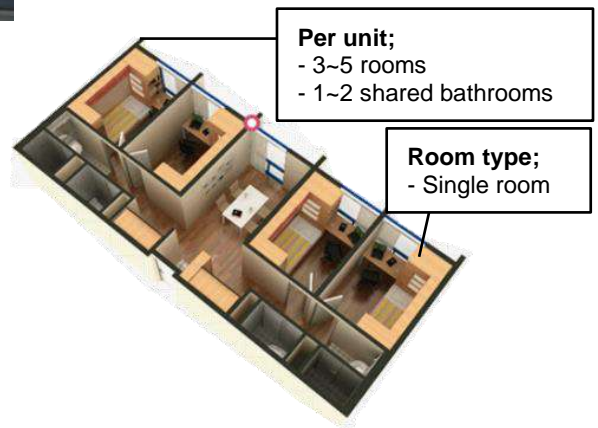

<Picture: Rooms in the International House>

All rooms are fully equipped with central heating, central air conditioning and free LAN internet access. Each occupant will use a single room but share a living room, shower room, toilet and laundry. The rooms are centrally air-conditioned but students can set the room temperature using the control switch. The electric voltage in Korea is 220V (60hz), and the standards wall socket has two rounded holes. Due to fire hazard reasons, the use of cooker, iron or coffeepot is strictly prohibited in the room. The International House has a community kitchen for students to cook their own food occasionally. Many international students use this community kitchen to cook their own ethnic food and share it with other international or Korean students.





<Community Kitchen & Cafeteria>

The Dormitory and International House provides coin operated laundry rooms and a gym for its residents' use. These are located on the basement floor and open 24 hours. Seminar rooms, student lounges, and an internet café are also available for the residents.

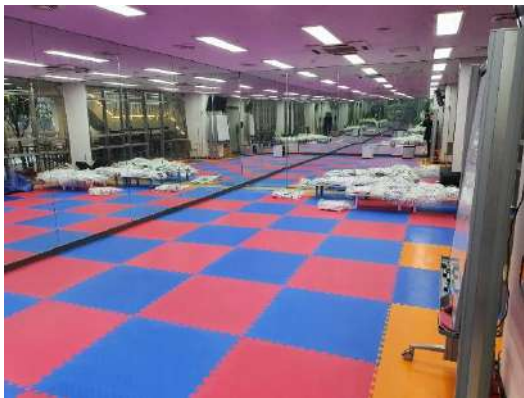

<RC Room and Gym>



<Laundry Room and Parcel Delivery Locker>



• *List of Electronic Devices adopted*

Type	Goods	Allowed?: Yes or No
Heating equipment	Electric blanket	NO
	Electric linoleum	NO
	Electric heater	NO
	Fan heater	NO
Cooking equipment	Boiler	NO
	Coffee maker	NO
	Toaster	NO
	Microwave	NO
	Electric frying pan	NO
	Gas burner	NO
	Electric rice cooker	NO
	Hot plate	NO
A/V equipment	VCR	NO
	TV	NO
	Electronic instrument	NO
Learning equipment	Desk lamp	YES
	Lap top	YES
	Printer	YES
Other equipment	Fan	NO
	Refrigerator	YES
	Mini air-conditioner	NO
	Vacuum	YES
	Hair dryer	YES
	Mobile Charger	YES

- **Certificate of Health** All of the residents have to submit the certificate of health to the Dormitory Office. (Every participant is to have a medical check-up upon arrival in Korea. The medical check-up report may replace the certificate of health in 1st semester. Before starting 2nd Semester, participants should submit Certificate of TB test.).
- **Dormitory Bedding** Bedding and pillows are not provided; participants are required to prepare their own blankets and pillows (Bedding materials can be purchased at the nearest store from school).
- **Automatic Face Recognition System** On your first day, you will have your photos taken at the dormitory office in order to be registered for dormitory access.
- **Laundry** You may do laundry after you buy a laundry card and charge it.
- **Cooking** Cooking is allowed at the Global Kitchen
- **Refrigerator** You can apply to rent to dormitory office. (10,000KRW / Month)
- **Residence Separation** Each female and male dormitory is out-of-bounds from each other.
- **Usage of Electricity** The authorization of electric goods may vary as mentioned below. In case of using prohibited electric goods, the goods will be seized with penalty points imposed to the user.

## 4. OTHER INFORMATION

### 1) University Library

The University of Seoul Libraries are dedicated to serve for the academic success of all UOS community members. The UOS Libraries are composed of the main library and the following two branch libraries

- Law Library
- Economics and Business Administration Library

#### Main Library

The Main Library is composed of reading rooms with 2,200 seats and houses almost 800,000 volumes of books, monographs and references. It also holds 1,466 different periodicals, 58,034 units of non-book materials and several online databases.

The Main Library opened the Digitalized Information Service Room in 1998, which allows users to access more non-book materials.



The expanded and computerized library system enables users to confirm, check, renew, reserve, check-out, purchase and send orders via the internet. In 1999, the Main Library reached an agreement with the National Assembly Library for the mutual exchange of academic information through the internet, thus facilitating access to vast amounts of information.

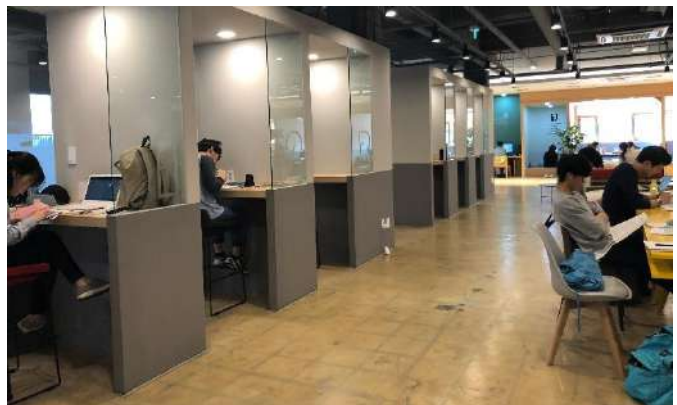

The Main Library also provides printing services for the full-text database of social science theses and dissertations. Most recently, the Main Library has created a new program which allows users better access to information on research resources, and has established the Integrated Retrieval System to facilitate easier access to multimedia data and e-books.



### Law Library

The law library was established as a branch of the UOS Libraries with a legal resource room, a postgraduate reading room, and information retrieval equipment in Floors 4~6 on October 2008. The library has 80,705 legal books (as of January 13, 2011) in 1,600<sup>m</sup> to support research activity, lecture, legal information investigation for the Graduate School of Law and legal area. On the 4th floor, it has group study rooms, an IT room, a laptop section and a lounge. On the 5th floor, it has a postgraduate reading room, an IT room and a preservation library. There is a legal study resource room including periodicals, reference books and articles on the 6 floor.

### Economics and Business Administration Library

The economics and business administration library was established as a branch with reading rooms, group study rooms and seminar rooms in Floor 3 on March 2011. The library has over 20,000 books, 70 periodicals and 15 database in 1,036.8<sup>m</sup> to support the research and learning activity of professors and students in management and economics. It has a 24 seat resource reading room, free reading rooms (148 seats), 5 study rooms (30 seats), a seminar room (8 seats), and information retrieval equipment (11 seats) to provide best service.

## 2) Computing Facilities

Many computer labs are available in UOS. In Korea, IBM is more widely used than MAC. The most accessible places to the Internet are the Student Lounge on the first floor in the 21 Century Building and Main Library. If you bring a laptop, you can access the Internet in your dorm room with the LAN cable which you need to prepare by yourself.



### 3) Bank and Money Exchange

Woori Bank is located on the first floor of the University Center Building. The business hours are from 9:00 to 16:00, Monday through Friday and it closes on weekends and holidays.

Foreign currency can be exchanged into Korean currency (won) in banks at the airport, foreign exchange banks, and other authorized money exchange places including the on-campus Woori Bank. Please note that only US Dollars, Euros, Japanese Yens and Chinese Yuans can be exchanged on-campus bank.

Global ATM can be found easily in Seoul. The ATM in the University Center Building is Global ATM.

### 4) On Campus Health Services

On Campus Health Services The University Health Service Center is located on the 2nd floor of Student Hall (#12 on the campus map). Examination, prescription and medicine for simple illnesses such as cold, indigestion and cuts will be treated free of charge. On 1st, 2nd weeks Wednesday and 3rd, 4th weeks Tuesday of the month between 14:00 ~ 16:00 in the afternoon. (not in the fifth week and vacation periods), Campus physician is available.

- Office Hour: Mon.-Fri., 09:00-18:00(12:00-13:00, Lunch Break)

### 5) Student Cafeteria, Snack Bars, and Convenience Stores

There are several cafeterias and snack bars on campus. They all serve different menus to meet the need of students and faculty.

#### ① Student Cafeterias and Snack Bars



Student Cafeterias are located in the Student Hall, in the Natural Science Building and in the dormitory. Korean dishes and western dishes are available. Prices normally range from 2,500 won to 6,000 won per



## PART IV. TRAINING INSTITUTE

person and it subjects to the menu of the day. The cafeterias run from 11:30 to 14:00 for lunch, from 15:00 to 18:30 for dinner on weekdays and are closed on weekends.

Location	Floor	Cafeterias/ Restaurants	Menu	Opening Hours (during semesters)	
				Weekdays	Weekends
Student Hall (#12 on the map)	1	Student Cafeteria	Korean Meals	Lunch 11:10-14:00 Dinner 17:00-18:40	Closed
	1	WEB	Fast Food	11:00-18:30	Closed
	2	Annekan	Western Style Meals	Lunch 11:30-14:00 Dinner 15:00-18:30	Closed
	2	Café Hyu	Drinks and Desserts	09:00-18:00	Closed
Natural Science Building (#8)	1	Student Cafeteria	Korean Meals	Lunch 11:30-13:30 Dinner 17:30-18:30	Closed
	1	Café BE	Drinks and Desserts	08:30-19:00	Closed
Law School (#20)	3	Paris Baguette	Bakery	09:00-18:00	Closed
Cheonnong Hall (#1)	1	Cheonnong Community Café	Drinks and Desserts	08:30-19:00	Closed
Main Library (#21)	1	Café Booktopia	Drinks and Desserts	24 hours(unmanned)	Closed
100th anniversary bldg.(#17)	1	Paris Baguette	Bakery	08:30-20:00	Closed



### ② Convenience Stores

Location	Floor	Convenience Store	Opening Hours (during semesters)	
			Weekdays	Saturdays
Student Hall	B1	CU	08:00-21:00	Closed
Main Library	B1	CU	08:00-22:00	08:00-22:00
Dormitory	1	CU	07:00-24:00	07:00-24:00

\* Opening hours during vacation may differ from above.

## 6) Post Office

The post office is located on the first floor of the Student Hall. The campus post office provides general mailing services including mail, parcel, registration, domestic and international EMS. The business hours are from 9:00 to 18:00.

## 7) University Gymnasium and Wellness Center



As a place for general physical education, the University Gymnasium and Sport Complex is used for instruction as well as for various sports and recreational activities. Various indoor and outdoor sport facilities and equipment are provided for such sports or recreational activities. The sports center has a fitness room and it costs 20,000 Won per a month. Some other facilities in the Gym include indoor tennis courts and squash courts.

## 8) Wi-Fi Service

Wi-Fi service is available within the campus. In order to have access to it, students are required to create an ID and PW on the university website and log on to the mobile or laptop device with the log-on information. Preferentially, students may directly visit the Computational Intelligence Service Office.

- Office Hour: Mon.-Fri., 09:00-18:00 (12:00-13:00, Lunch Break)
- Location: [IT Help Desk](#), 5th floor, University Center (#7 on the campus map)

## 9) Student ID Card

The Student ID card is mainly used for library, entering the building, checking-out & returning books, etc. It will be ready for pick-up at the IUDP office from the second week of the semester.

**10) Alien Registration**

All foreigners planning to stay in Korea for more than 90 days must report to the Seoul Immigration Office and register for the Alien Registration Card within 90days from the date of arrival. To be eligible for the Alien Registration, students should hold a long-term D-2 visa. Alien Registration will be done during the preliminary session and students will be accompanied by the program coordinator to the immigration office. It takes about a month to have the Alien Residence Card issued.

- ***Required documents:***

- Alien Registration Form
- Certificate of Enrollment
- Passport
- 1 ID photo(3.5cm\*4.5cm)
- Registration fee: 30,000won (Fees may increase.)



## Map of University of Seoul



- |   |  |
|---|--|
| 1 Cheonnong Hall                              | 2 The 1st Engineering Building                       |
| 3 Architecture and Civil Engineering Building | 4 Changgong Building                                 |
| 5 Liberal Arts Building                       | 6 Baebong Hall                                       |
| 7 University Center                           | 8 Natural Science Building                           |
| 9 Music Building                              | 10 Kyongnong Hall                                    |
| 11 The 2nd Engineering Building               | 12 Student Hall                                      |
| 13 University Press ROTC Building             | 14 Science and Technology Building                   |
| 15 The 21st Century Building                  | 16 Design and Sculpture Building                     |
| 17 Citizens Culture Education Center          | 18 Birch Hall  |
| 19 Information and Technology Building        | 20 Law School  |
| 21 Main Library                               | 22 Student Dormitory                                 |
| 23 Building Structure Experimental Building   | 24 Civil Engineering Structure Experimental Building |
| 25 Media Building                             | 26 Automation Greenhouse                             |
| 27 Main Auditorium                            | 28 Main Stadium                                      |
| 29 University Museum                          | 30 Front door  |
| 31 Back door                                  | 32 Wellness Center                                   |
| 33 Mirae Hall                                 | 34 International House                               |
| 35 Sky Pond                                   |  |

## 5. HEALTH CARE

The University Health Service Center is located on the 2nd floor of the Student Hall. (Open from 9:00 to 18:00 except Saturday and Sunday) Examination, prescription and medicine for simple illnesses such as cold or indigestion will be offered without cost. On every Wednesday between 14:00~16:00 (exception of vacation), Campus physician is available.

- **On Campus Health Services** The University Health Service Center is located on the 2nd floor of Student Hall (#12 on the campus map). Examination, prescription and medicine for simple illnesses such as cold, indigestion and cuts will be treated free of charge.  
- Office Hour: Mon.-Fri., 09:00-18:00(12:00-13:00, Lunch Break)

### Campus physician available

On 1st, 2nd weeks Wednesday and 3rd, 4th weeks Tuesday of the month between 14:00 ~ 16:00 in the afternoon. (However, the fifth week and vacation periods not care)

- **Off-campus Hospitals**
  - Samyook Medical Center (삼육서울병원)  
Sundays & Weekdays: 09:00-17:00, Fridays: 09:00-12:00  
Contact: 1577-3675
  - St. Paul's Hospital (성바오로병원)  
Weekdays: 08:30-17:00(12:30-13:30, Lunch Break), Saturdays: 08:30-12:00  
Contact: 02-958-2114
  - Seoul Sungsim General Hospital (서울성심병원)  
Weekdays: 09:00-17:30(12:30-13:30, Lunch Break), Saturdays: 09:00-13:00  
Contact: 02-966-1616

<b>Part V</b>	<b>SUPPORT SERVICE</b>
---------------	------------------------

## 1. TRAVEL TO KOREA

UOS arranges and pays for the participant to travel to and from Korea. The participant is to travel by the most direct route between Incheon International airport and a main international airport in the participant's home country. UOS will cover economy class, round-trip airfare.

If a participant wants to change the flight itineraries, he or she should pay the additional fare. The participant is responsible for the issuance of a visa necessary for this Scholarship Program.

If a participant accompanies or invites family members, he or she must be responsible for all the relevant costs and other necessary administrative measures (please refer to the "4. Accompanying or Inviting Family" Section of Part 7. Regulations).

## 2. EXPENSES FOR STUDY AND LIVING

The following expenses will be covered by SMG-UOS during the participant's stay in Korea.

- Tuition & Dormitory fees
- Economy class, round-trip airfare between Seoul and the Participant's home country
- Textbook and materials
- Monthly living allowance based on SMG regulations
- Others: A medical checkup after arrival / Official field trip expense

### 3. INSURANCE

During the program participants will be covered by the national health insurance (NHI). The insurance covers expenses for medical treatment and hospital care caused by diseases or accidents within the scope and limit of insurance coverage.

#### What's Covered

While there are all kinds of specifics, the first question when asking if you're covered is, are you receiving inpatient or outpatient treatment? Get checked into a hospital, and all of the sudden your bills are now 80% covered. They told you to stay the night at the hospital, but you just had to go home, huh? That move could have you paying up to 40% more for your medical bill.

Next, the coverage you get largely depends on where you're being treated. This is another great way that the system encourages efficient distribution of limited healthcare resources. There are four different classifications of hospitals in Korea: clinic (개인병원, 의원), hospital (병원), general hospital (종합병원), and tertiary hospital (대학병원). A tertiary care hospital (or university hospital) is a large facility equipped with a full complement of services and departments, typically housing the most experienced and widest range of specialist doctors. Wouldn't everyone want to go there to get the care they needed if they could? Well, outpatient treatments at these expensive facilities are only 40% covered – leaving you with 60% of the bill, and you even need a referral from a local clinic to get in. Those who demand tertiary level care without a doctor's referral can expect to foot 100% of the bill on their own. This prevents people from cluttering the schedules of the best doctors in the country with minor ailments. The percentage of coverage grows to 70% with a local, privately-owned clinic, encouraging people to visit there to save money – and encouraging doctors to open and operate many local hospitals in Korea. Isn't it nice to have that local ENT clinic? You can thank this aspect of the system for that.

Preventive care also keeps costs down, and public health promotion is emphasized through the 100% coverage of a general health exam offered to everyone covered either annually or biannually, depending on income level. Screenings for at-risk age groups for stomach, breast, liver, colorectal and cervical cancer are 90% covered. Lung cancer examinations are omitted from this list, so the individual is responsible for the

30-50% copayment generally applied depending on the facility.

The degree to which a country is “advanced” or not is often measured by the rate of death for children under one year of age, or what’s called the “infant mortality rate.” Korea manages to rank an impressive #22 on the list (Singapore is #1, and the United States is #34), thanks to excellent prenatal and childbirth coverage. According to an insider with the NHI, the out-of-pocket delivery expenses from a public hospital are in the W380,000 to W500,000 range for a natural birth, and closer to W700,000 for a cesarean section. Additionally, an expectant mother can make a request from her doctor to receive what is commonly called the “pink card” or “Go Mom” card, this card can essentially be likened to a W500,000 gift, exclusively for pre-natal checkups or pregnancy-related expenses. This program can be especially beneficial for low income families, and helps ensure that every expectant mother can have a fair chance at bringing a healthy baby into this world. Also, all care for infants under 28 days is 100% covered and infants under six years of age are covered 100% for a total of six health examinations.

For those who incur major health care expenses such as long term inpatient care or non-elective surgeries, it is comforting to know that there is also a “Compensation for Excessive Co-payment.” In cases where the co-payment exceeds KRW 1,200,000 within 30 days: 50% of excess amount covered by NHIS.

### What’s NOT Covered

As great as NHI in Korea really is, it is not without its faults, inconsistencies, or outright mystery. Nowhere in the company literature is a line by line breakdown of what is NOT covered, and even the call center representatives provided an “it depends on the situation” canned response upon being pressed for specifics.

One that you can be confident of is that an MRI is **not** covered, unless the disease you are being treated for falls in the cancer and catastrophic disease category. This is why every sizeable hospital in Korea has an MRI machine and frequently encourages you to get your very own MRI scan; it’s a big profit center.

There is another rather surprising way that the NHIS manages to provide so much coverage while keeping prices low. As the mission of the NHIS is for “coverage for illness and the promotion of health,” they ensure that people are held responsible for their actions with a policy that states that **accidents and physical injuries not covered.**

That’s right. Break your arm skiing? Break open the piggy bank next. Hit a pedestrian

with your bicycle? You'll be the one paying for their medical bills. An elevator breaks and you're stuck in it when it falls? At least you can expect that the building owner will have to pay for your medical bills.

While most medical professionals must adhere to government price setting, some fields are **not** specifically covered by the NHIS, allowing them to charge whatever they'd like, which can therefore be more lucrative. What's not covered?

*"Non-Benefit" Item*

- Medicine, medical material, or medical service that is provided or used for a disease that does not affect a patient's daily life seriously
- Medicine, medical material, or medical service that does not improve the essential bodily functions: i.e.) Cosmetic surgery, freckle treatment, snoring treatment
- Exception: Case of reconstructive surgery for burned face, which disrupts masticatory movement"

Being able to charge whatever you want for snoring treatment may nice, but the fields most doctors turn to is obviously plastic surgery and dermatology. Now you know one of the big reasons Korea is the plastic surgery capital of Asia; because it is a profitable field, so many of the best surgeons often choose it as a specialty.

Before we let you go, there's one important organization that we need to tell you about. The "Health Insurance Review and Assessment Service" (HIRA), is a governmental organization commissioned with "determining whether the payments claimed by healthcare institutions are clinically valid, formulated in a cost-effective manner, and calculated according to the Benefit Coverage Standards stipulated in the National Health Insurance Act." This means that they're your watchdog, and if you feel that you have been overcharged in some way on your medical bills, then you have a place to turn. Visit [hira](#) for more information.

Although not perfect, Korean NHI is one of the most cost effective and efficient health programs in the world. For those of us who are covered, we can rest well with the knowledge that we can expect high quality service that is both affordable and effective for the vast majority of health issues we may face.

Obviously we can't cover everything here. For more information, visit [nhis](#) or email [intl@nhis.or.kr](mailto:intl@nhis.or.kr).

## 4. SAFETY MANAGEMENT

University of Seoul and International School of Urban sciences will provide participants with a series of education to support their smooth settlement in terms of individual's physical and mental safety.

- Crime prevention education
- Sexual harassment prevention education
- Dormitory life education
- Seasonal climate education

### Support for maladjusted students

When students have some troubles in adjustment to Korean life, UOS will take the following steps to support their situation.

- Support participants in cooperation with the principal professors, course staff, and fellow participants
- If professional treatment is required, firstly psychotherapy is provided with a professor at the student counseling center.
- Secondary treatment at a general hospital linked to the school should be performed to ease the burden of treatment expenses.

#### **Campus physician**

On 1st, 2nd weeks Wednesday and 3rd, 4thweeks Tuesday of the month between 14:00 ~ 16:00 in the afternoon. (However, the fifth week and vacation periods not available)

#### **UOS human rights center – Counselling service**

Monday through Friday 09:00 ~ 18:00

- Psychological examination
- Counseling on human rights violations
- Consultation and declaration of sexual harassment sexual violence

<b>Part VI</b>	<b>REGULATIONS</b>
----------------	--------------------

**1. PARTICIPANT'S RESPONSIBILITIES**

Participants are required:

- To take up the scholarship in the academic year for which it is offered (deferral is not allowed)
- To reside in the accommodation designated by UOS for the duration of the course except for holidays or temporary leave
- To maintain an appropriate study load and achieve satisfactory academic progress for the course. If the participant fails to attain certain grades required by UOS, his or her status as a MUAP program participant may be suspended
- To participate in all activities associated with the approved course of study including all lectures and tutorials, submit all work required for the course and sit for examinations unless approved otherwise by UOS in advance
- To notify the Program Chair and the UOS office two weeks prior to the departure by submitting the "Request for a temporary leave" document. The e-ticket should also be submitted when issued.
- To advise UOS of any personal or family circumstances such as health problems or family problems which may seriously affect their study
- To agree to SMG collecting information concerning them and passing that information onto other relevant parties, if necessary
- To return to their home country upon completion of their training program
- Not to extend the length of their training program or stay for personal convenience; neither SMG nor UOS will provide any assistance and be responsible for an extension of their stay
- To either return to their original job post or remain employed in a field related to their degree for at least 3 years.
- To recommend not to purchase personal vehicles with their allowances provided by SMG due to safety concerns and concentration on their studies.



## 2. WITHDRAWALS

- In principle, a participant is not allowed to withdraw from the course at his or her own option once the course starts.
- A participant may withdraw with valid personal or relating to issues from one's home country (such as health or work issues) when acceptable to UOS. In this case, he/she is not allowed to re-apply for MUAP program for the next two years after the withdrawal.
- If a participant fails to attain certain grades required by UOS, he or she may be forced to withdraw and return home upon withdrawal. In this case, he/she is not allowed to re-apply for MUAP program.
- The participant who withdraws must return to UOS the living allowance he or she has already received for the remaining period from the date of departure from Korea.

## 3. TEMPORARY LEAVE

- Participants can have a temporary leave [in winter/summer vacation](#) (to the participants' home country or for a trip abroad), pursuant to the permission from the Program Chair. In such cases, SMG and UOS do not pay airfare for the trip.
- The Program Chair may grant an extension of a temporary leave, based on an Academic Petition with valid grounds. UOS will not pay the living allowance for the absent days ([including the day of departure and arrival](#)): Notwithstanding this clause, the research trips accompanied by a professor or the duly-authorized personnel shall not be counted as the days for a temporary leave so long as the participant is approved by the Program Chair, and in such cases, the payment of living allowance shall not be deducted.
- If the participant is found to have made an unreported temporary visit to his or her home country or traveled to other countries or made a trip without the university's disapproval, his or her living allowance will be suspended (from the day of departure to the day of return), and UOS may impose a disciplinary action on them, including the expulsion from UOS.

#### **4. ACCOMPANYING OR INVITING FAMILY**

- As MUAP Program is quite an intensive program which requires students of full commitment to and concentrated endeavors for studying, participants are required not to bring any family members.
- UOS does not provide any financial or other administrative support for the dependents of the participants.
- Participants may invite family members within a month to the fullest under the condition that the Program Chair approves the invitation in advance. But they must be able to cover all the relevant expenses such as airfare, accommodation, living cost, visa fee, insurance, etc. of their family. The responsibility for the safety and security of their family may also fall upon the participants.

#### **5. OTHERS**

- SMG-UOS will assume responsibility only within the limit and scope of the insurance for participants.
- SMG-UOS is not liable for any damage or loss of the participant's personal property.
- SMG-UOS will not assume any responsibility for illness, injury, or death of the participant arising from extracurricular activities, willful misconduct, or undisclosed pre-existing medical conditions.
- If the participants break any of the rules of SMG and UOS during their stay in Korea, their status as a MUAP program participant may be suspended.

**Part VII****CONTACTS****❑ Seoul Metropolitan Government (SMG)**

- Program Manager: Ms. Shin, Hyejin
- Phone: +82-2-2133-5272
- Fax: +82-2-768-8826
- E-mail: [hyejinshin@seoul.go.kr](mailto:hyejinshin@seoul.go.kr)
- Address: 110 Sejong-daero, Jung-gu, Seoul 04524, Republic of Korea

**❑ International School of Urban Sciences (ISUS), University of Seoul**

- Program Manager: Mr. Gumin JUNG; Ms. Hyemi KIM; Ms. Dabin KIM
- Phone: +82-2-6490-5197
- Fax: +82-2-6490-5141
- E-mail: [muap@uos.ac.kr](mailto:muap@uos.ac.kr)
- Home page: <http://isus.uos.ac.kr/>
- Address: Room 412, Law School, University of Seoul, 163 Seoulsiribdae-ro, Dongdaemun-gu, Seoul 02504, Republic of Korea

